

Technical data sheet

Polyamide manifolds

Contents

DESCRIPTION	3
ADVANTAGES	4
TECHNICAL FEATURES 6P00.H6.P10 - 1"	5
COMPONENTS 6P00.H6.P10 - 1"	6
DIMENSIONS 6P00.H6.P10 - 1"	8
TECHNICAL FEATURES 6P00.H6.P12 - 1.1/4"	9
COMPONENTS 6P00.H6.P12 - 1.1/4"	11
DIMENSIONS 6P00.H6.P12 - 1.1/4"	12

Polyamide manifolds

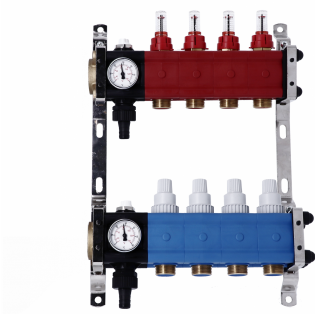

DESCRIPTION

They are made of high-tech thermoplastic material designed for underfloor heating and cooling systems. They are complete with flow rate displays with a graduated scale, with a total shut-off function on the flow module; each individual return module is equipped with a thermostat insert.

The new 'High Sensitivity' range of flowmeters allows a perfect combination with the latest generation of variable circulators.

Water distribution in the various circuits can be carried out through plastic, multilayer or copper pipes up to a diameter of 20 mm.

The low pressure losses, a feature due to the special design of the flow and return modules, allow any supply to the heating circuits without any resonance.

ADVANTAGES

- High-tech thermoplastic material
- "High-sensitivity" flowmeters
- Low pressure drops
- Suitable for plastic, multilayer and copper pipes

TECHNICAL FEATURES 6P00.H6.P10 - 1"



Technical Data

Max glycol percentage	0.5
Standard working pressure	1,5 ÷ 2,5 bar
Maximum operating pressure	6 bar
Test pressure	8 bar
Working temperature range	4°C ÷ 70°C
Manifold connection	1" F
Shunt	3/4" M Eurocone
Centre distance	50mm
Box depth	80mm

S

COMPONENTS 6P00.H6.P10 - 1"

Modules, the air vent block, the head and the terminal which make up the manifold are joined with 6 MA threaded bars inserted in the 4 holes of each component. Tightening of the nuts positioned on the head is performed with a torque spanner to ensure seal evenness and stability between parts.

Each assembled manifold undergoes strict tests to guarantee functionality and fluid passage sealing.

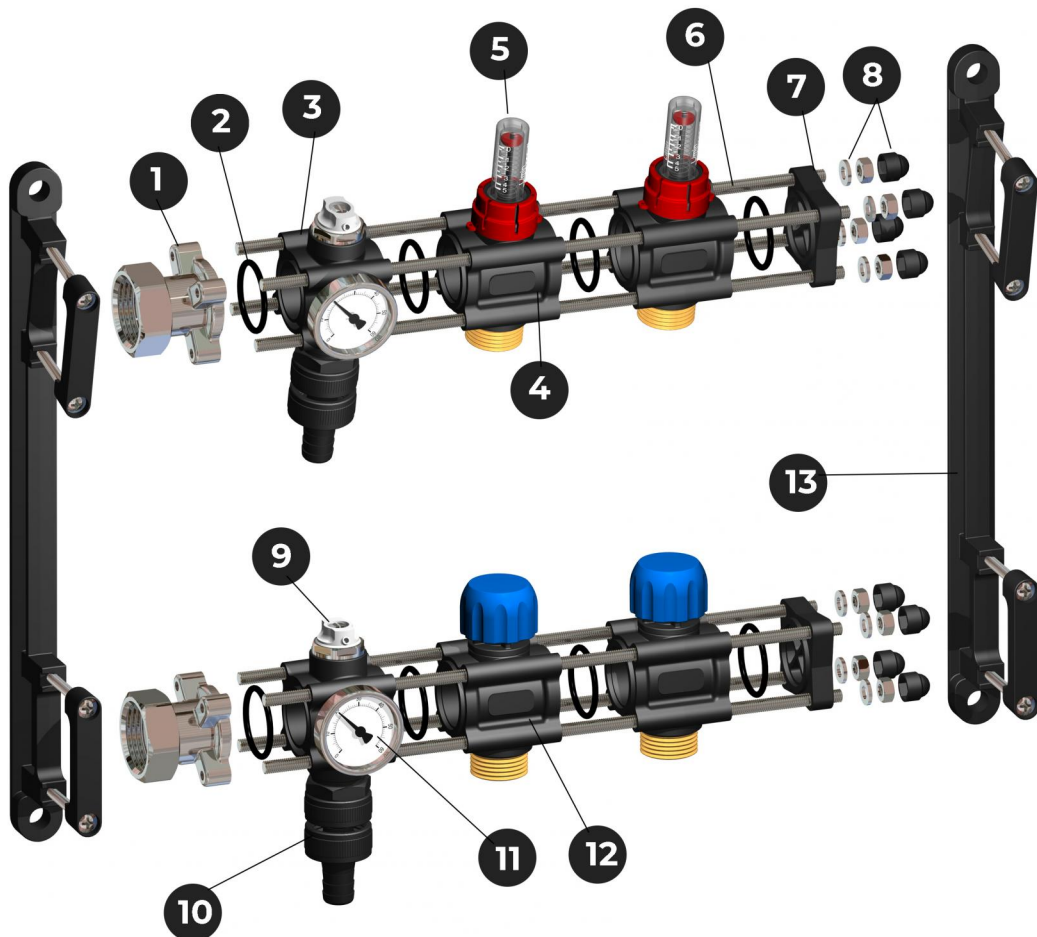

Legenda - Legend	Componenti - Components
1	1" brass head with free nut
2	O-Ring
3	Modulo testata - Head Module
4	Modulo di mandata - Supply Module
5	Flussimetro - Flow meter
6	Barra filettata - Threaded bar
7	Terminale - Plastic end
8	Nuts & plastic covers
9	Air vent

Legenda - Legend	Componenti - Components
10	Charge/Discharge valve
11	Thermometer
12	Return module
13	Bracket

DIMENSIONS 6P00.H6.P10 - 1"

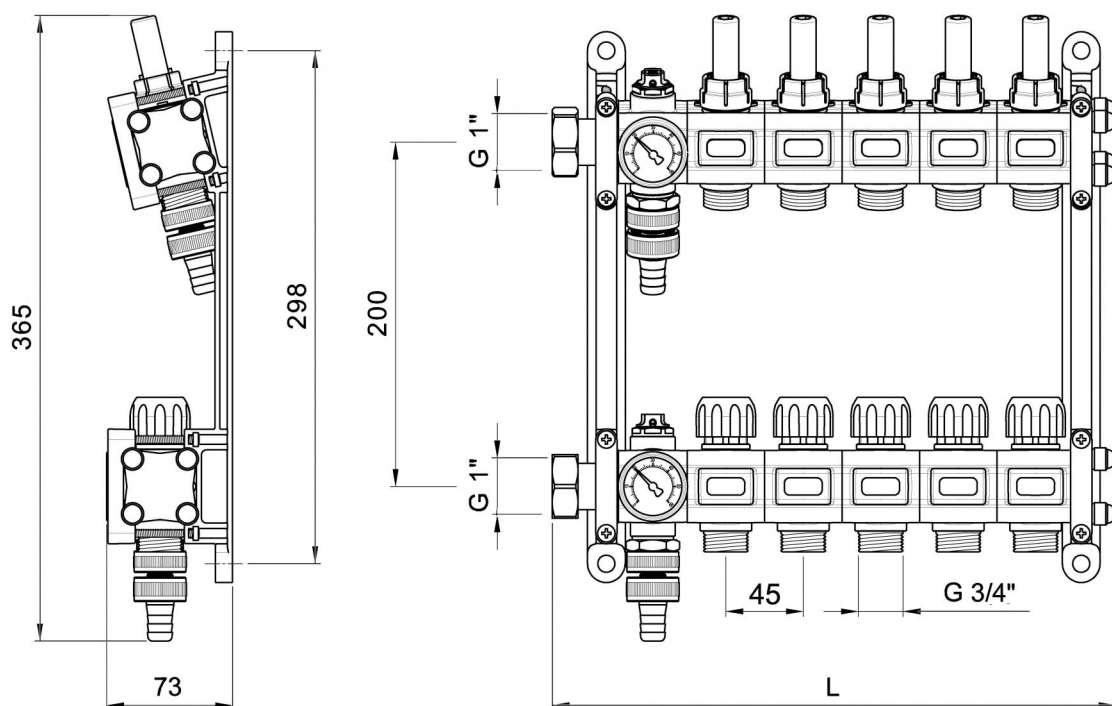

Loops	L
2	205
3	255
4	305
5	355
6	405
7	455
8	505

Loops	L
9	555
10	605
11	655
12	705
13	755

S

TECHNICAL FEATURES 6P00.H6.P12 - 1.1/4"

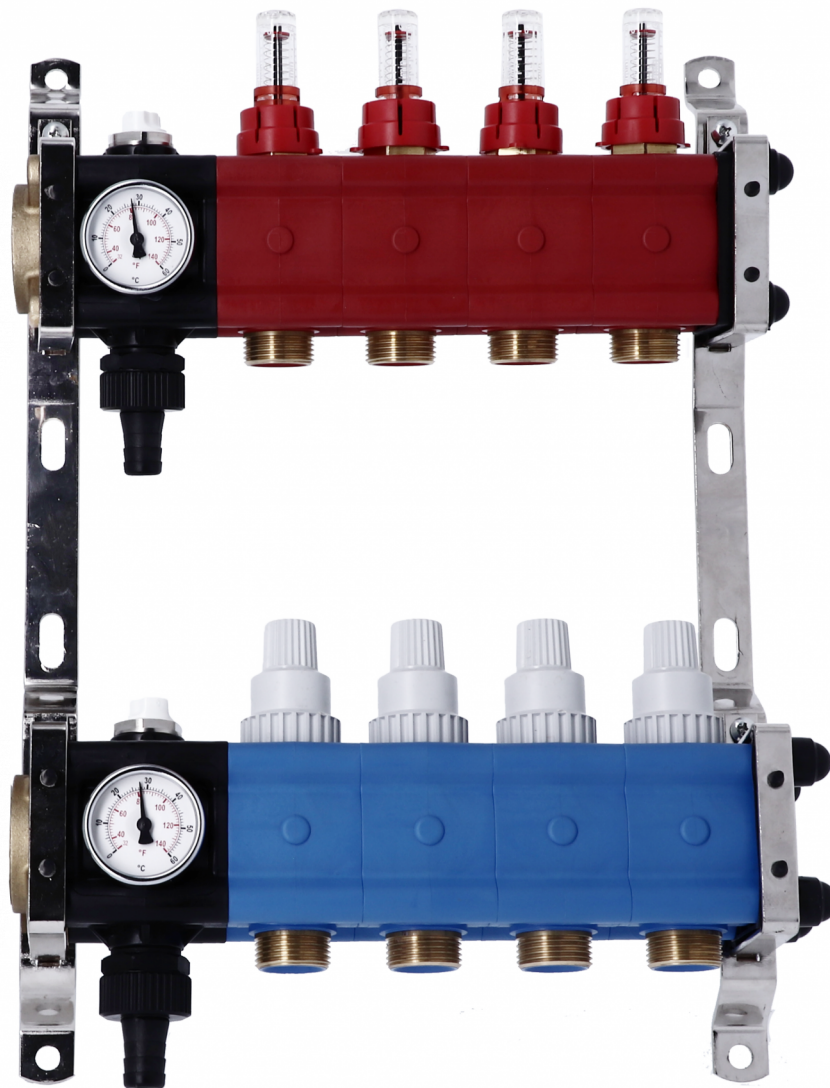

Technical Data

Max glycol percentage	0.5
Standard working pressure	1,5 ÷ 2,5 bar
Maximum operating pressure	6 bar
Test pressure	8 bar
Working temperature range	4°C ÷ 70°C
Manifold connection	1 1/4" F
Shunt	3/4" M Eurocone

Technical Data

Centre distance	45mm
Box depth	110mm

S

COMPONENTS 6P00.H6.P12 - 1.1/4"

Modules, the air vent block, the head and the terminal which make up the manifold are joined with 6 MA threaded bars inserted in the 4 holes of each component.

Tightening of the nuts positioned on the head is performed with a torque spanner to ensure seal evenness and stability between parts.

Each assembled manifold undergoes strict tests to guarantee functionality and fluid passage sealing.

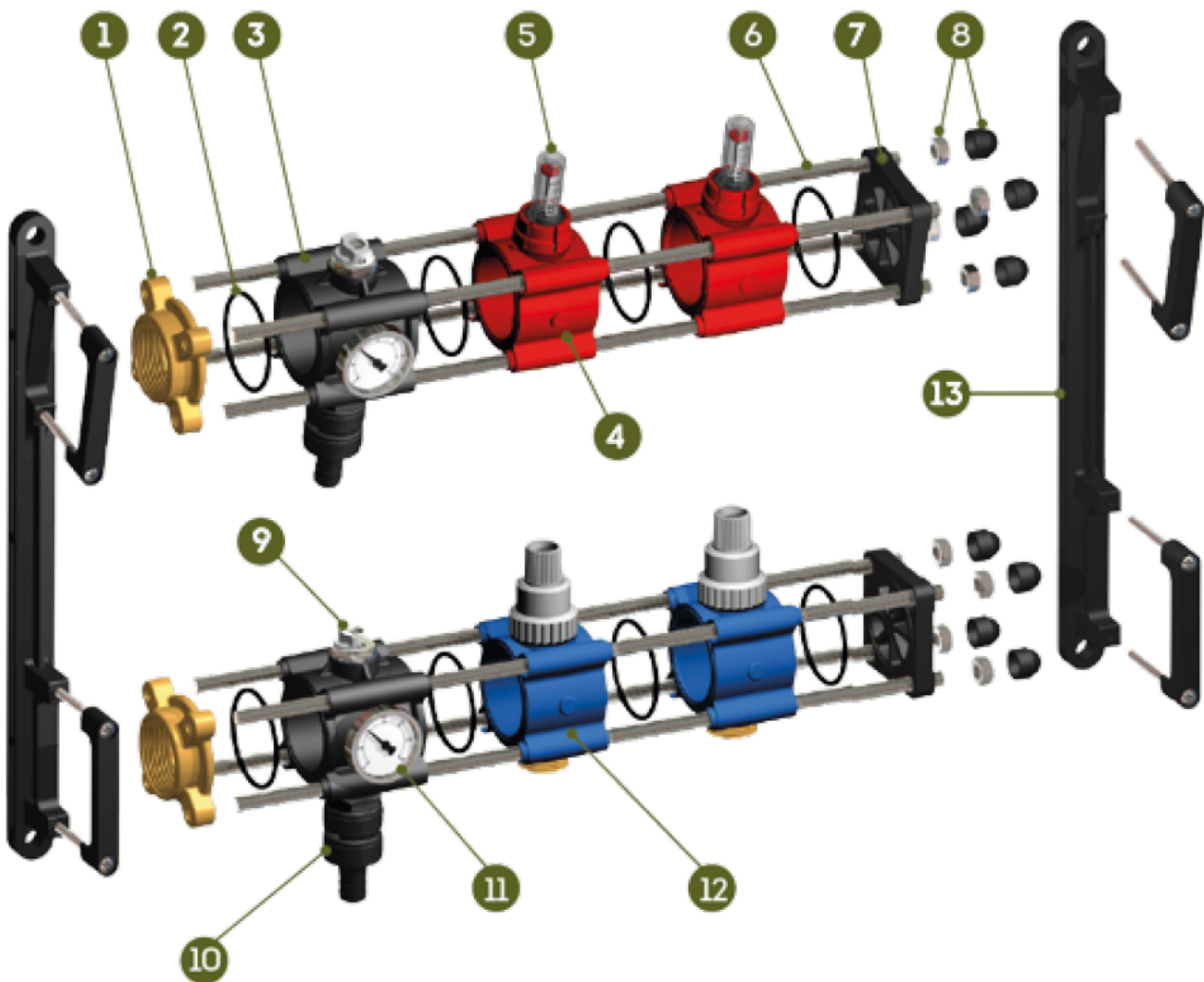

Key	Components
1	1 1/4" Brass head
2	O-ring
3	Head module
4	Supply module
5	Flowmeter
6	Threaded bar
7	End part
8	Nuts & plastic covers
9	Air vent
10	Charge/Discharge valve
11	Thermometer
12	Return module
13	Bracket

DIMENSIONS 6P00.H6.P12 - 1.1/4"

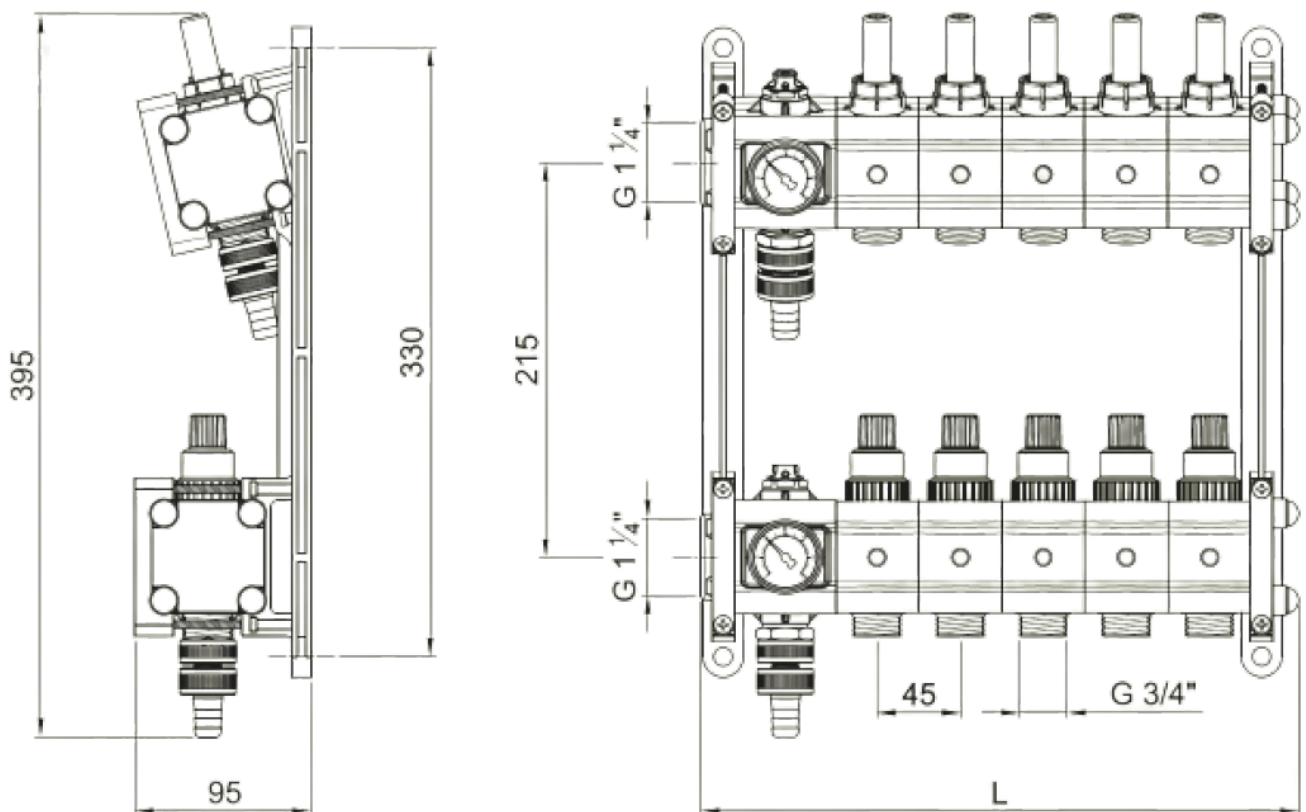

Loops	L
2	190
3	235
4	280
5	325
6	370
7	415
8	460
9	505
10	550
11	595
12	640
13	685
14	730
15	775
16	820



GENERAL FITTINGS SPA

Via Golgi 73/75, 25064 Gussago (BS) - ITALY

te. +39 030 3739017

www.generalfittings.it